

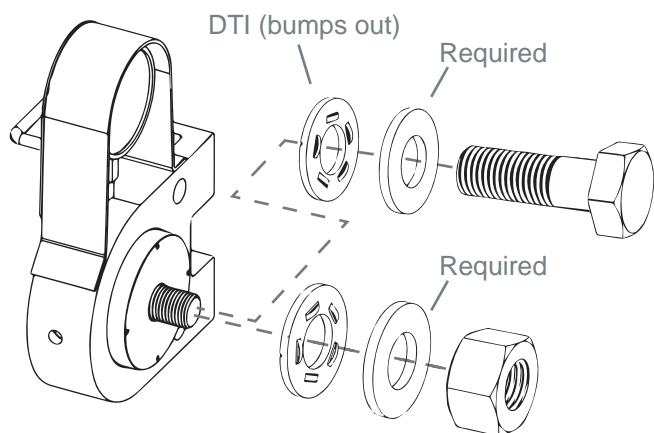

Verification

Step 1



Assemble hardware in a tension calibrator.

Step 2

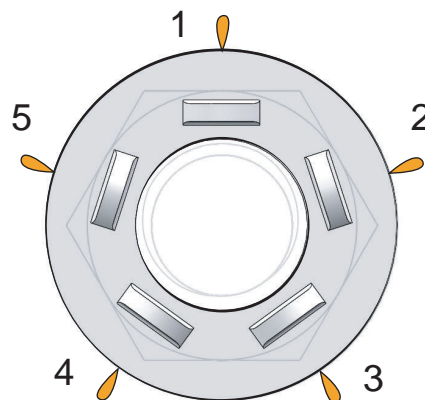

Tighten until the DuraSquirt® DTI has orange visible at all bump locations.

Step 3



Confirm the tension is at or above the requirement.

Completely flat is acceptable after full squirt.

The visual inspection method is now confirmed for use in the steelwork.

DuraSquirt® DTI Installation and Inspection

Assemble

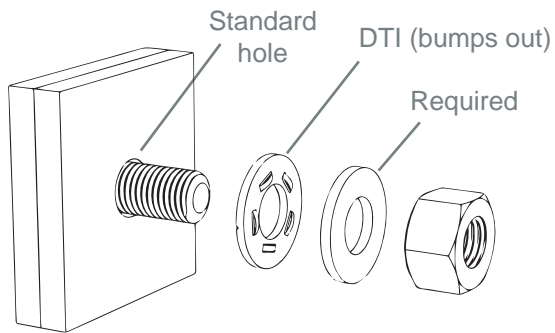

Recommended

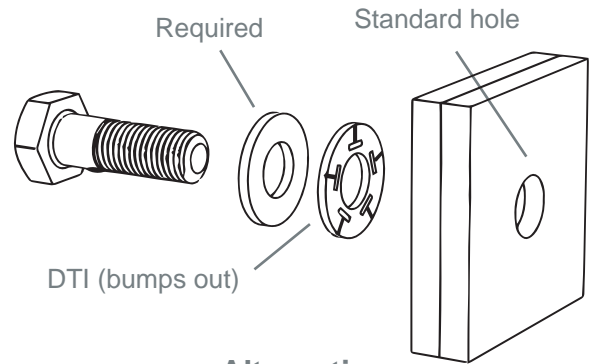

Alternative

Snug

Bring the steelwork together before orange is visible at all bump locations.

Tighten DuraSquirt® DTI

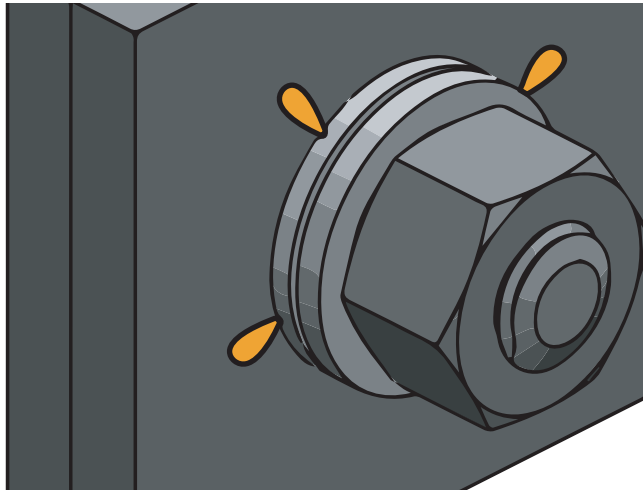

Tighten until the DuraSquirt® DTI has orange visible at all bump locations.

Inspect

Verify Durasquirt® DTI has orange visible at all bump locations.

If it's not easy call us! We want you hanging iron.

(802) 460-3100 or **appliedbolting.com**

Check the website for bolting resources; Including test forms.

Videos, and Tips



Scan for support